



ProSite LED Floodlight

Technical Specification Sheet - CE / RCM / ATEX / IECEx

ProSite LED Floodlight - CE / RCM / ATEX / IECEx F1 Models



Patent Pending

Certifications & Ratings

- 10 year warranty
- CE / ENEC / RCM
- ATEX/IECEX Zone 2, 21 & 22
 - Ex ec IIC T4 Gc
 - Ex tb IIIC T110°C Db
 - ITS-I 22 ATEX 29411X
 - ITS-I 22 ATEX 294111X
 - IECEx ETL 22.0001X
- IP66/67
- DNV
- IK10 (integrated PC optic/lens/lens cover), IK08 (glass lens cover)
- L70 > 150,000 hours @ 25°C ambient

Angled Bracket

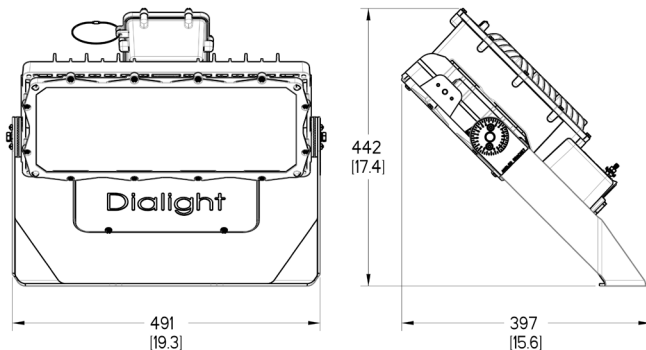

Dimensions in mm [inches]
Additional dimensional drawings on pages 12-13

Mechanical Information:

Fixture weight:	10.9 - 13.6 kg
Shipping weight:	~14.5 kg
EPA (m²):	0.186
Mounting: (all with 7.5° tilting increments)	316 stainless steel straight bracket 316 stainless steel angled bracket Slipfitter bracket
Cable entry:	2 x M25

Electrical Specifications:

Operating voltage:	120-277 VAC / 120-250 VDC 347-415-480 VAC
Operating temp:	-40°C to +65°C
EMC:	CISPR 15 FCC 47CFR 15 IEC 61000-3-3 IEC 61547 IEC 61000-3-2
Transient protection:	6KV/3KA combination wave, as per IEEE C62.41, line-line and line-ground.
Optional:	10kV/5kA for non-hazardous models 20kV/10kA single strike
THD:	< 20%
Power Factor:	> 0.9
Dimming:	DALI 2.0 compatible/0-10 VDC Optional wireless dimming via Dialight IntelliLED controls

Construction:

Housing:	A360 Die-cast aluminum
Hardware:	316 stainless steel
Finish:	Superior epoxy and polyester dual coat finish
Lens:	Integrated PC Optic/Lens, Glass Lens Cover, PC Lens Cover

Photometric Information:

CRI:	70 (80 optional)
CCT:	5000K (cool white) 4000K (neutral white) 2200K (warm white) 2700K (warm white) - 80 CRI Amber
Beam pattern:	Medium - 55° Wide - 125° Very Wide - 131° x 108° Asymmetric - Forward Distribution Asymmetric Wide

IES files: Available at www.dialight.com

All values typical unless otherwise stated (tolerance +/- 10%)

WARNING - INSTALLATION & SECONDARY RETENTION. Use of any Dialight products without proper installation (including secondary retention / netting) and periodic inspections could cause severe injury or death. Dialight recommends that all installations should use secondary retention / netting (appropriate to the installation environment) where applicable. It is the exclusive responsibility of the contractor, installer and/or end-user to: (a) determine the suitability of the product for its intended application; and, (b) ensure that the product is safely installed (with secondary retention / netting where appropriate) and in compliance with all applicable laws and regulations. To the extent permissible under applicable laws, Dialight disclaims all liability for personal injury and/or other damage resulting from any dislodgment or other dislocation of its products.

Ordering Information - F1

ProSite LED Floodlight - CE / RCM



Industrial - CE / RCM							
Part Number	Fixture Lumens	Wattage	lm/W	Voltage	CCT	Lens	Beam Distribution
12,000lm Models							
F1E-N7B2-BDEN-VGN	13,200	81	163	120-277VAC / 120-250VDC	5000k (cool white)	Integrated PC	Very Wide (131° x 108°)
F1E-N6B2-BDEN-VGN	13,200	81	163	120-277VAC / 120-250VDC	5000k (cool white)	Integrated PC	Wide (125°)
F1E-N4B2-BDEN-VGN	13,200	81	163	120-277VAC / 120-250VDC	5000k (cool white)	Integrated PC	Medium (56°)
F1E-7FB2-BDEN-VGN	12,200	81	151	120-277VAC / 120-250VDC	5000k (cool white)	Glass	Asymmetric
F1E-N7L2-BDEN-VGN	13,200	81	163	120-277VAC / 120-250VDC	4000k (neutral white)	Integrated PC	Very Wide (131° x 108°)
F1E-N6L2-BDEN-VGN	13,200	81	163	120-277VAC / 120-250VDC	4000k (neutral white)	Integrated PC	Wide (125°)
F1E-N4L2-BDEN-VGN	13,200	81	163	120-277VAC / 120-250VDC	4000k (neutral white)	Integrated PC	Medium (56°)
F1E-7FL2-BDEN-VGN	12,200	81	151	120-277VAC / 120-250VDC	4000k (neutral white)	Glass	Asymmetric
18,000lm Models							
F1E-N7B2-CDEN-VGN	19,100	124	154	120-277VAC / 120-250VDC	5000k (cool white)	Integrated PC	Very Wide (131° x 108°)
F1E-N6B2-CDEN-VGN	19,100	124	154	120-277VAC / 120-250VDC	5000k (cool white)	Integrated PC	Wide (125°)
F1E-N4B2-CDEN-VGN	19,100	124	154	120-277VAC / 120-250VDC	5000k (cool white)	Integrated PC	Medium (56°)
F1E-7FB2-CDEN-VGN	17,700	124	143	120-277VAC / 120-250VDC	5000k (cool white)	Glass	Asymmetric
F1E-N7L2-CDEN-VGN	19,100	124	154	120-277VAC / 120-250VDC	4000k (neutral white)	Integrated PC	Very Wide (131° x 108°)
F1E-N6L2-CDEN-VGN	19,100	124	154	120-277VAC / 120-250VDC	4000k (neutral white)	Integrated PC	Wide (125°)
F1E-N4L2-CDEN-VGN	19,100	124	154	120-277VAC / 120-250VDC	4000k (neutral white)	Integrated PC	Medium (56°)
F1E-7FL2-CDEN-VGN	17,700	124	143	120-277VAC / 120-250VDC	4000k (neutral white)	Glass	Asymmetric
30,000lm Models							
F1E-N7B2-FDEN-VGN	31,600	234	135	120-277VAC / 120-250VDC	5000k (cool white)	Integrated PC	Very Wide (131° x 108°)
F1E-N6B2-FDEN-VGN	31,600	234	135	120-277VAC / 120-250VDC	5000k (cool white)	Integrated PC	Wide (125°)
F1E-N4B2-FDEN-VGN	31,600	234	135	120-277VAC / 120-250VDC	5000k (cool white)	Integrated PC	Medium (56°)
F1E-7FB2-FDEN-VGN	29,200	234	125	120-277VAC / 120-250VDC	5000k (cool white)	Glass	Asymmetric
F1E-N7L2-FDEN-VGN	31,600	234	135	120-277VAC / 120-250VDC	4000k (neutral white)	Integrated PC	Very Wide (131° x 108°)
F1E-N6L2-FDEN-VGN	31,600	234	135	120-277VAC / 120-250VDC	4000k (neutral white)	Integrated PC	Wide (125°)
F1E-N4L2-FDEN-VGN	31,600	234	135	120-277VAC / 120-250VDC	4000k (neutral white)	Integrated PC	Medium (56°)
F1E-7FL2-FDEN-VGN	29,200	234	125	120-277VAC / 120-250VDC	4000k (neutral white)	Glass	Asymmetric
Amber Models							
F1E-7FA2-BDEN-VGN	11,700	226	52	120-277VAC / 120-250VDC	Amber	Glass	Asymmetric

All values typical unless otherwise stated (tolerance +/- 10%).

Part numbers listed in **bold** are typically available in stock.

Voltage - For 347-415-480 VAC change the 7th character to '5'.

CCT - For 2700k change 6th character to 'W'. For 2200k change 6th character to 'U'. Refer to lumen table on page 7 for accurate values.

Lens - For glass lens cover change 4th character to a '7', For PC lens cover change 4th character to a '4'. Lens option '4' and '7' not available for asymmetric wide optic.

Surge Protection - For 10kV surge protection 120-277 VAC change 7th character to '8'. For 10kV surge protection 347-415-480 VAC change 7th character to '9'.

PE Cell - For NEMA PE Cell Receptacle with shorting cap change 9th character to 'S'.

Mounting Bracket - Angled Bracket supplied as standard - for straight bracket change 10th character to 'F'.

WARNING - INSTALLATION & SECONDARY RETENTION. Use of any Dialight products without proper installation (including secondary retention / netting) and periodic inspections could cause severe injury or death. Dialight recommends that all installations should use secondary retention / netting (appropriate to the installation environment) where applicable. It is the exclusive responsibility of the contractor, installer and/or end-user to: (a) determine the suitability of the product for its intended application; and, (b) ensure that the product is safely installed (with secondary retention / netting where appropriate) and in compliance with all applicable laws and regulations. To the extent permissible under applicable laws, Dialight disclaims all liability for personal injury and/or other damage resulting from any dislodgment or other dislocation of its products.

Ordering Information - F1

ProSite LED Floodlight - CE / RCM / ATEX / IECEx



Hazardous - ATEX/IECEx Zone 2, 21, 22							
Part Number	Fixture Lumens	Wattage	lm/W	Voltage	CCT	Lens	Beam Distribution
12,000lm Models							
F1B-77B2-BDEN-VGN	12,500	81	154	120-277VAC / 130 - 250VDC	5000k (cool white)	Glass	Very Wide (131° x 108°)
F1B-76B2-BDEN-VGN	12,500	81	154	120-277VAC / 130 - 250VDC	5000k (cool white)	Glass	Wide (125°)
F1B-74B2-BDEN-VGN	12,500	81	154	120-277VAC / 130 - 250VDC	5000k (cool white)	Glass	Medium (56°)
F1B-7FB2-BDEN-VGN	12,200	81	151	120-277VAC / 130 - 250VDC	5000k (cool white)	Glass	Asymmetric
F1B-77L2-BDEN-VGN	12,500	81	154	120-277VAC / 130 - 250VDC	4000k (neutral white)	Glass	Very Wide (131° x 108°)
F1B-76L2-BDEN-VGN	12,500	81	154	120-277VAC / 130 - 250VDC	4000k (neutral white)	Glass	Wide (125°)
F1B-74L2-BDEN-VGN	12,500	81	154	120-277VAC / 130 - 250VDC	4000k (neutral white)	Glass	Medium (56°)
F1B-7FL2-BDEN-VGN	12,200	81	151	120-277VAC / 130 - 250VDC	4000k (neutral white)	Glass	Asymmetric
18,000lm Models							
F1B-77B2-CDEN-VGN	18,000	124	145	120-277VAC / 130 - 250VDC	5000k (cool white)	Glass	Very Wide (131° x 108°)
F1B-76B2-CDEN-VGN	18,000	124	145	120-277VAC / 130 - 250VDC	5000k (cool white)	Glass	Wide (125°)
F1B-74B2-CDEN-VGN	18,000	124	145	120-277VAC / 130 - 250VDC	5000k (cool white)	Glass	Medium (56°)
F1B-7FB2-CDEN-VGN	17,700	124	143	120-277VAC / 130 - 250VDC	5000k (cool white)	Glass	Asymmetric
F1B-77L2-CDEN-VGN	18,000	124	145	120-277VAC / 130 - 250VDC	4000k (neutral white)	Glass	Very Wide (131° x 108°)
F1B-76L2-CDEN-VGN	18,000	124	145	120-277VAC / 130 - 250VDC	4000k (neutral white)	Glass	Wide (125°)
F1B-74L2-CDEN-VGN	18,000	124	145	120-277VAC / 130 - 250VDC	4000k (neutral white)	Glass	Medium (56°)
F1B-7FL2-CDEN-VGN	17,700	124	143	120-277VAC / 130 - 250VDC	4000k (neutral white)	Glass	Asymmetric
30,000lm Models							
F1B-77B2-FDEN-VGN	29,900	234	128	120-277VAC / 130 - 250VDC	5000k (cool white)	Glass	Very Wide (131° x 108°)
F1B-76B2-FDEN-VGN	29,900	234	128	120-277VAC / 130 - 250VDC	5000k (cool white)	Glass	Wide (125°)
F1B-74B2-FDEN-VGN	29,900	234	128	120-277VAC / 130 - 250VDC	5000k (cool white)	Glass	Medium (56°)
F1B-7FB2-FDEN-VGN	29,200	234	125	120-277VAC / 130 - 250VDC	5000k (cool white)	Glass	Asymmetric
F1B-77L2-FDEN-VGN	29,900	234	128	120-277VAC / 130 - 250VDC	4000k (neutral white)	Glass	Very Wide (131° x 108°)
F1B-76L2-FDEN-VGN	29,900	234	128	120-277VAC / 130 - 250VDC	4000k (neutral white)	Glass	Wide (125°)
F1B-74L2-FDEN-VGN	29,900	234	128	120-277VAC / 130 - 250VDC	4000k (neutral white)	Glass	Medium (56°)
F1B-7FL2-FDEN-VGN	29,200	234	125	120-277VAC / 130 - 250VDC	4000k (neutral white)	Glass	Asymmetric
Amber Models							
F1B-7FA2-BDEN-VGN	11,700	226	52	120-277VAC / 130 - 250VDC	Amber	Glass	Asymmetric

All values typical unless otherwise stated (tolerance +/- 10%).

Part numbers listed in **bold** are typically available in stock.

CCT - For 2700k change 6th character to 'W'. For 2200k change 6th character to 'U'

Mounting Bracket - Angled Bracket supplied as standard - for straight bracket change 10th character to 'F'.

WARNING - INSTALLATION & SECONDARY RETENTION. Use of any Dialight products without proper installation (including secondary retention / netting) and periodic inspections could cause severe injury or death. Dialight recommends that all installations should use secondary retention / netting (appropriate to the installation environment) where applicable. It is the exclusive responsibility of the contractor, installer and/or end-user to: (a) determine the suitability of the product for its intended application; and, (b) ensure that the product is safely installed (with secondary retention / netting where appropriate) and in compliance with all applicable laws and regulations. To the extent permissible under applicable laws, Dialight disclaims all liability for personal injury and/or other damage resulting from any dislodgment or other dislocation of its products.

ProSite LED Floodlight - CE / RCM / ATEX / IECEx F2 Models



Patent Pending

Certifications & Ratings

- 10 year warranty
- CE / ENEC / RCM
- ATEX/IECEx Zone 2, 21 & 22
 - Ex ec IIC T4 Gc
 - Ex tb IIIC T110°C Db
 - ITS-I 22 ATEX 29411X
 - ITS-I 22 ATEX 294111X
 - IECEx ETL 22.0001X
- IP66/67
- DNV
- IK10 (integrated PC optic/lens/lens cover), IK08 (glass lens cover)
- L70 > 150,000 hours @ 25°C ambient

Angled Bracket

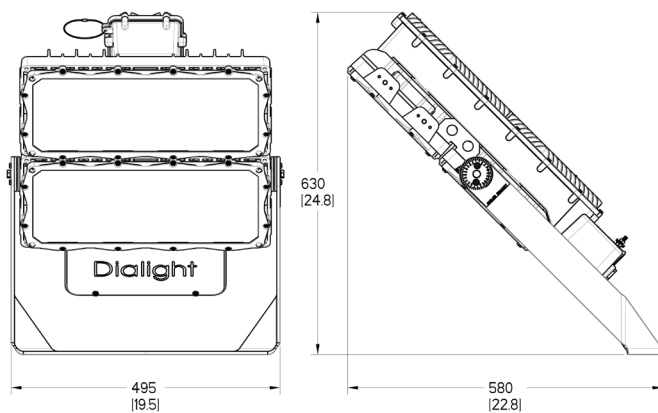

Dimensions in mm [inches]
Additional dimensional drawings on pages 12-13

Mechanical Information:

Fixture weight:	19.5 - 24.5 kg
Shipping weight:	~25.5 kg
EPA (m²):	0.310
Mounting:	316 stainless steel straight bracket (all with 7.5° tilting increments) 316 stainless steel angled bracket
Cable entry:	2 x M25

Electrical Specifications:

Operating voltage:	120-277 VAC / 120-250 VDC 347-415-480 VAC
Operating temp:	-40°C to +65°C -40°C to +55°C - 60klm
EMC:	CISPR 15 FCC 47CFR 15 IEC 61000-3-3 IEC 61547 IEC 61000-3-2
Transient protection:	6KV/3KA combination wave, as per IEEE C62.41, line-line and line-ground.
Optional:	10kV/5kA for non-hazardous models 20kV/10kA single strike
THD:	< 20%
Power Factor:	> 0.9
Dimming:	DALI 2.0 compatible/0-10 VDC Optional wireless dimming via Dialight IntelliLED controls (up to 36klm only)

Construction:

Housing:	A360 Die-cast aluminum
Hardware:	316 stainless steel
Finish:	Superior epoxy and polyester dual coat finish
Lens:	Integrated PC Optic/Lens, Glass Lens Cover, PC Lens Cover

Photometric Information:

CRI:	70 (80 optional)
CCT:	5000K (cool white) 4000K (neutral white) 2200K (warm white) 2700K (warm white) - 80 CRI Amber
Beam pattern:	Medium - 55° Wide - 125° Very Wide - 131° x 108° Asymmetric - Forward Distribution Asymmetric Wide

IES files: Available at www.dialight.com

All values typical unless otherwise stated (tolerance +/- 10%)

WARNING - INSTALLATION & SECONDARY RETENTION. Use of any Dialight products without proper installation (including secondary retention / netting) and periodic inspections could cause severe injury or death. Dialight recommends that all installations should use secondary retention / netting (appropriate to the installation environment) where applicable. It is the exclusive responsibility of the contractor, installer and/or end-user to: (a) determine the suitability of the product for its intended application; and, (b) ensure that the product is safely installed (with secondary retention / netting where appropriate) and in compliance with all applicable laws and regulations. To the extent permissible under applicable laws, Dialight disclaims all liability for personal injury and/or other damage resulting from any dislodgment or other dislocation of its products.

Ordering Information - F2

ProSite LED Floodlight - CE / RCM



Industrial - CE / RCM							
Part Number	Fixture Lumens	Wattage	lm/W	Voltage	CCT	Lens	Beam Distribution
60,000lm Models - 10kV Surge Protection							
F2E-N7B8-NDEN-VGN	65,000	484	134	120-277VAC / 120-250VDC	5000k (cool white)	Integrated PC	Very Wide (131° x 108°)
F2E-N6B8-NDEN-VGN	65,000	484	134	120-277VAC / 120-250VDC	5000k (cool white)	Integrated PC	Wide (125°)
F2E-N4B8-NDEN-VGN	65,000	484	134	120-277VAC / 120-250VDC	5000k (cool white)	Integrated PC	Medium (56°)
F2E-7FB8-NDEN-VGN	60,100	484	124	120-277VAC / 120-250VDC	5000k (cool white)	Glass	Asymmetric
F2E-N7L8-NDEN-VGN	65,000	484	134	120-277VAC / 120-250VDC	4000k (neutral white)	Integrated PC	Very Wide (131° x 108°)
F2E-N6L8-NDEN-VGN	65,000	484	134	120-277VAC / 120-250VDC	4000k (neutral white)	Integrated PC	Wide (125°)
F2E-N4L8-NDEN-VGN	65,000	484	134	120-277VAC / 120-250VDC	4000k (neutral white)	Integrated PC	Medium (56°)
F2E-7FL8-NDEN-VGN	60,100	484	124	120-277VAC / 120-250VDC	4000k (neutral white)	Glass	Asymmetric
Amber Models							
F2E-7FA2-EDEN-VGN	20,500	461	44	120-277VAC / 120-250VDC	Amber	Glass	Asymmetric
60,000lm Models - 415 VAC 10kV Surge Protection							
F2E-N7B9-NDEN-VGN	65,000	499	130	347-415VAC	5000k (cool white)	Integrated PC	Very Wide (131° x 108°)
F2E-N6B9-NDEN-VGN	65,000	499	130	347-415VAC	5000k (cool white)	Integrated PC	Wide (125°)
F2E-N4B9-NDEN-VGN	65,000	499	130	347-415VAC	5000k (cool white)	Integrated PC	Medium (56°)
F2E-7FB9-NDEN-VGN	60,100	499	120	347-415VAC	5000k (cool white)	Glass	Asymmetric
F2E-N7L9-NDEN-VGN	65,000	499	130	347-415VAC	4000k (neutral white)	Integrated PC	Very Wide (131° x 108°)
F2E-N6L9-NDEN-VGN	65,000	499	130	347-415VAC	4000k (neutral white)	Integrated PC	Wide (125°)
F2E-N4L9-NDEN-VGN	65,000	499	130	347-415VAC	4000k (neutral white)	Integrated PC	Medium (56°)
F2E-7FL9-NDEN-VGN	60,100	499	120	347-415VAC	4000k (neutral white)	Glass	Asymmetric

All values typical unless otherwise stated (tolerance +/- 10%).
 Part numbers listed in **bold** are typically available in stock.
 Voltage - For 347-415 VAC change the 7th character to '5'.
 CCT - For 2700k change 6th character to 'W'. For 2200k change 6th character to 'U'. Refer to lumen table on page 7 for accurate values.
 Lens - For glass lens cover change 4th character to a '7'. For PC lens cover change 4th character to a '4'.
 PE Cell - For NEMA PE Cell Receptacle with shorting cap change 9th character to 'S'.
 Mounting Bracket - Angled Bracket supplied as standard - for straight bracket change 10th character to 'F'.



Hazardous - ATEX/IECEx Zone 2, 21, 22							
Part Number	Fixture Lumens	Wattage	lm/W	Voltage	CCT	Lens	Beam Distribution
60,000lm Models							
F2B-77B2-NDEN-VGN	61,400	484	127	120-277VAC / 130-250VDC	5000k (cool white)	Glass	Very Wide (131° x 108°)
F2B-76B2-NDEN-VGN	61,400	484	127	120-277VAC / 130-250VDC	5000k (cool white)	Glass	Wide (125°)
F2B-74B2-NDEN-VGN	61,400	484	127	120-277VAC / 130-250VDC	5000k (cool white)	Glass	Medium (56°)
F2B-7FB2-NDEN-VGN	60,100	484	124	120-277VAC / 130-250VDC	5000k (cool white)	Glass	Asymmetric
F2B-77L2-NDEN-VGN	61,400	484	127	120-277VAC / 130-250VDC	4000k (neutral white)	Glass	Very Wide (131° x 108°)
F2B-76L2-NDEN-VGN	61,400	484	127	120-277VAC / 130-250VDC	4000k (neutral white)	Glass	Wide (125°)
F2B-74L2-NDEN-VGN	61,400	484	127	120-277VAC / 130-250VDC	4000k (neutral white)	Glass	Medium (56°)
F2B-7FL2-NDEN-VGN	60,100	484	124	120-277VAC / 130-250VDC	4000k (neutral white)	Glass	Asymmetric
Amber Models							
F2B-7FA2-EDEN-VGN	20,500	461	44	120-277VAC / 130-250VDC	Amber	Glass	Asymmetric

All values typical unless otherwise stated (tolerance +/- 10%).
 CCT - For 2700k change 6th character to 'W'. For 2200k change 6th character to 'U'. Refer to lumen table on page 7 for accurate values.
 Mounting Bracket - Angled Bracket supplied as standard - for straight bracket change 10th character to 'F'.

WARNING - INSTALLATION & SECONDARY RETENTION. Use of any Dialight products without proper installation (including secondary retention / netting) and periodic inspections could cause severe injury or death. Dialight recommends that all installations should use secondary retention / netting (appropriate to the installation environment) where applicable. It is the exclusive responsibility of the contractor, installer and/or end-user to: (a) determine the suitability of the product for its intended application; and, (b) ensure that the product is safely installed (with secondary retention / netting where appropriate) and in compliance with all applicable laws and regulations. To the extent permissible under applicable laws, Dialight disclaims all liability for personal injury and/or other damage resulting from any dislodgment or other dislocation of its products.

Lumen Tables

Lumen Output Family	Optic	PC Optic Only				Glass Lens				Polycarbonate Lens			
		5000K	4000K	2700K	2200K	5000K	4000K	2700K	2200K	5000K	4000K	2700K	2200K
12,000	Medium	13,200	13,200	10,200	10,400	12,500	12,500	9,500	9,700	11,700	11,700	8,800	9,000
	Wide	13,200	13,200	10,200	10,400	12,500	12,500	9,500	9,700	11,700	11,700	8,800	9,000
	Very Wide	13,200	13,200	10,200	10,400	12,500	12,500	9,500	9,700	11,700	11,700	8,800	9,000
	Asymmetric	-	-	-	-	12,200	12,200	9,200	9,400	11,500	11,500	8,500	8,700
	Asymmetric Wide	12,300	12,300	9,300	9,500	-	-	-	-	-	-	-	-
18,000	Medium	19,100	19,100	14,800	15,100	18,000	18,000	13,800	14,000	17,000	17,000	12,700	13,000
	Wide	19,100	19,100	14,800	15,100	18,000	18,000	13,800	14,000	17,000	17,000	12,700	13,000
	Very Wide	19,100	19,100	14,800	15,100	18,000	18,000	13,800	14,000	17,000	17,000	12,700	13,000
	Asymmetric	-	-	-	-	17,700	17,700	13,400	13,700	16,600	16,600	12,300	12,600
	Asymmetric Wide	17,800	17,800	13,500	13,800	-	-	-	-	-	-	-	-
24,000	Medium	25,000	25,000	19,400	19,800	23,600	23,600	18,000	18,400	22,300	22,300	16,600	17,000
	Wide	25,000	25,000	19,400	19,800	23,600	23,600	18,000	18,400	22,300	22,300	16,600	17,000
	Very Wide	25,000	25,000	19,400	19,800	23,600	23,600	18,000	18,400	22,300	22,300	16,600	17,000
	Asymmetric	-	-	-	-	23,100	23,100	17,500	17,900	21,800	21,800	16,100	16,500
	Asymmetric Wide	23,300	23,300	17,600	18,000	-	-	-	-	-	-	-	-
F1 30,000	Medium	31,600	31,600	24,500	25,000	29,900	29,900	22,800	23,200	28,100	28,100	21,000	21,500
	Wide	31,600	31,600	24,500	25,000	29,900	29,900	22,800	23,200	28,100	28,100	21,000	21,500
	Very Wide	31,600	31,600	24,500	25,000	29,900	29,900	22,800	23,200	28,100	28,100	21,000	21,500
	Asymmetric	-	-	-	-	29,200	29,200	22,100	22,600	27,500	27,500	20,400	20,900
	Asymmetric Wide	29,400	29,400	22,300	22,800	-	-	-	-	-	-	-	-
F2 30,000	Medium	32,000	32,000	24,800	25,300	30,200	30,200	23,000	23,500	28,500	28,500	21,300	21,800
	Wide	32,000	32,000	24,800	25,300	30,200	30,200	23,000	23,500	28,500	28,500	21,300	21,800
	Very Wide	32,000	32,000	24,800	25,300	30,200	30,200	23,000	23,500	28,500	28,500	21,300	21,800
	Asymmetric	-	-	-	-	29,600	29,600	22,400	22,900	27,800	27,800	20,600	21,100
	Asymmetric Wide	29,800	29,800	22,600	23,000	-	-	-	-	-	-	-	-
36,000	Medium	37,500	37,500	29,100	29,600	35,400	35,400	27,000	27,600	33,400	33,400	24,900	25,500
	Wide	37,500	37,500	29,100	29,600	35,400	35,400	27,000	27,600	33,400	33,400	24,900	25,500
	Very Wide	37,500	37,500	29,100	29,600	35,400	35,400	27,000	27,600	33,400	33,400	24,900	25,500
	Asymmetric	-	-	-	-	34,700	34,700	26,300	26,800	32,600	32,600	24,200	24,800
	Asymmetric Wide	34,900	34,900	26,400	27,000	-	-	-	-	-	-	-	-
48,000	Medium	51,000	51,000	39,500	40,300	48,200	48,200	36,700	37,500	45,400	45,400	33,900	34,700
	Wide	51,000	51,000	39,500	40,300	48,200	48,200	36,700	37,500	45,400	45,400	33,900	34,700
	Very Wide	51,000	51,000	39,500	40,300	48,200	48,200	36,700	37,500	45,400	45,400	33,900	34,700
	Asymmetric	-	-	-	-	47,200	47,200	35,700	36,500	44,400	44,400	32,900	33,700
	Asymmetric Wide	47,400	47,400	36,000	36,700	-	-	-	-	-	-	-	-
60,000	Medium	65,000	65,000	50,400	51,400	61,400	61,400	46,800	47,800	57,900	57,900	43,200	44,200
	Wide	65,000	65,000	50,400	51,400	61,400	61,400	46,800	47,800	57,900	57,900	43,200	44,200
	Very Wide	65,000	65,000	50,400	51,400	61,400	61,400	46,800	47,800	57,900	57,900	43,200	44,200
	Asymmetric	-	-	-	-	60,100	60,100	45,500	46,500	56,600	56,600	41,900	42,900
	Asymmetric Wide	60,500	60,500	45,800	46,800	-	-	-	-	-	-	-	-

Lumen Family	Optic	PC Optic Only		Glass Lens		Polycarbonate Lens	
		Amber		Amber		Amber	
F1 12,000	Medium	13,000		12,300		11,600	
	Wide	13,000		12,300		11,600	
	Very Wide	13,000		12,300		11,600	
	Asymmetric	-		11,600		10,500	
	Asymmetric Wide	11,700		-		-	
F2 24,000	Medium	23,000		21,700		20,500	
	Wide	23,000		21,700		20,500	
	Very Wide	23,000		21,700		20,500	
	Asymmetric	-		20,600		18,500	
	Asymmetric Wide	20,700		-		-	

In Rush Current

Lumen Output	In rush current @ input voltage			Time duration of in rush current @ input voltage		
	120 VAC	277 VAC	415 VAC	120 VAC	277 VAC	415 VAC
60,000	15	36	10	1.5mS	1.5ms	.9ms
48,000	15	36	10	1.5mS	1.5ms	.9ms
36,000	8	18	5	1.5mS	1.5ms	.9ms
30,000	8	18	5	1.5mS	1.5ms	.9ms
24,000	8	18	5	1.5mS	1.5ms	.9ms
18,000	8	18	5	1.5mS	1.5ms	.9ms
12,000	8	18	5	1.5mS	1.5ms	.9ms
Amber 24,000	15	36	10	1.5mS	1.5ms	.9ms
Amber 12,000	8	18	5	1.5mS	1.5ms	.9ms

Maximum per Circuit Breaker

120 VAC			
Lumen Output	10 Amp	16 Amp	20 Amp
12,000	9	14	17
18,000	6	9	11
24,000	4	6	8
30,000 F1	3	5	6
30,000F2	4	6	7
36,000	3	5	6
48,000	2	3	4
60,000	1	2	3
12,000 Amber	3	5	6
24,000 Amber	2	2	3

240 VAC		
10 Amp	16 Amp	20 Amp
17	28	35
11	18	23
8	13	16
6	10	12
7	11	14
6	10	12
4	7	8
3	5	6
6	10	13
3	5	6

277 VAC			
Lumen Output	10 Amp	16 Amp	20 Amp
12,000	20	32	40
18,000	13	21	26
24,000	9	15	19
30,000 F1	7	11	14
30,000F2	8	13	16
36,000	7	11	14
48,000	5	8	9
60,000	3	5	7
12,000 Amber	7	12	14
24,000 Amber	4	6	7

415 VAC		
10 Amp	16 Amp	20 Amp
29	47	58
19	31	38
14	22	27
10	17	21
12	19	24
10	16	20
7	11	14
5	8	10
11	17	21
5	8	10

Dialight recommends using B or C type breakers

DISCLAIMER. All product information provided is, to the best of Dialight's knowledge, accurate as of the date of publication. When ordering, refer to www.dialight.com for current versions of: (a) relevant product documentation (including the relevant product data sheets); (b) Dialight terms and conditions of sale; and, (c) the relevant product warranty. To the extent that any contract is deemed formed between Dialight and the purchaser of Dialight products and/or an end-user, versions of documents available at www.dialight.com as at the date of sale shall be the versions incorporated therein. In the event of any discrepancy between this document or information provided at www.dialight.com, the latter shall prevail.

Beam Distribution

Medium - 55°

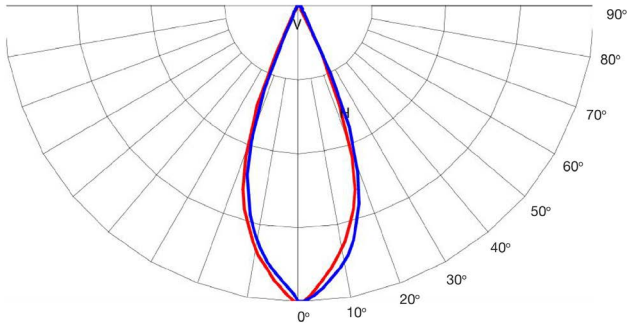

Wide - 125°

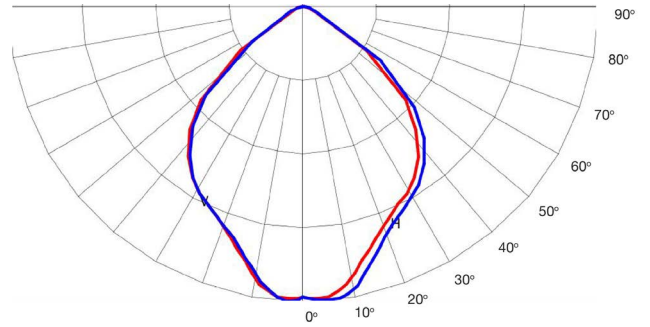

Very Wide - 131°x108°

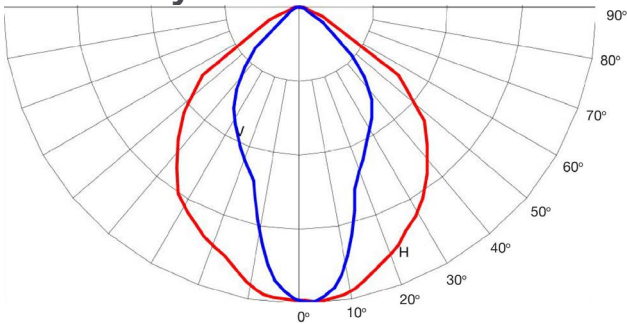

Asymmetric - Forward Distribution

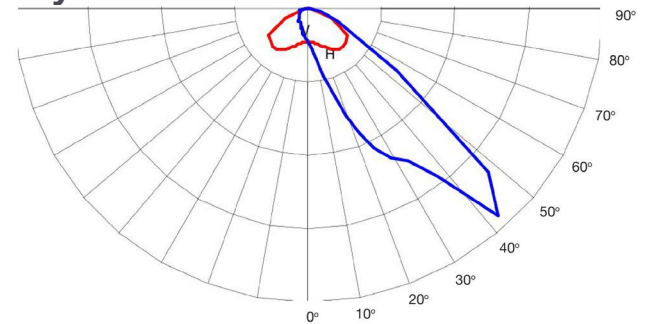

Asymmetric Wide

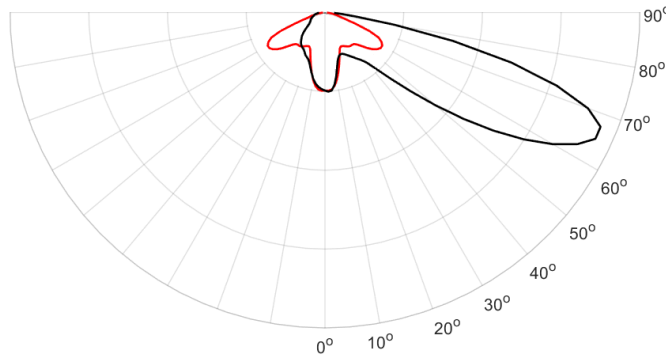

DISCLAIMER. All product information provided is, to the best of Dialight's knowledge, accurate as of the date of publication. When ordering, refer to www.dialight.com for current versions of: (a) relevant product documentation (including the relevant product data sheets); (b) Dialight terms and conditions of sale; and, (c) the relevant product warranty. To the extent that any contract is deemed formed between Dialight and the purchaser of Dialight products and/or an end-user, versions of documents available at www.dialight.com as at the date of sale shall be the versions incorporated therein. In the event of any discrepancy between this document or information provided at www.dialight.com, the latter shall prevail.

Lumen Maintenance Factor - F1

F1 Floodlight 12k lm (Hours)									
Ambient	0	15000	30000	45000	60000	75000	90000	100000	150000
25°C	100%	98%	97%	96%	96%	95%	94%	93%	91%
30°C	99%	97%	96%	95%	95%	94%	93%	92%	90%
35°C	98%	96%	96%	95%	95%	94%	93%	92%	90%
40°C	98%	96%	95%	94%	94%	93%	92%	91%	89%
45°C	97%	95%	94%	93%	93%	92%	91%	90%	88%
50°C	96%	94%	94%	93%	93%	92%	91%	90%	88%
55°C	96%	94%	93%	92%	91%	90%	90%	89%	87%
60°C	95%	93%	92%	91%	91%	90%	89%	89%	86%
65°C	94%	92%	92%	91%	90%	89%	88%	88%	85%

F1 Floodlight 18k lm (Hours)									
Ambient	0	15000	30000	45000	60000	75000	90000	100000	150000
25°C	100%	98%	97%	96%	96%	95%	94%	93%	91%
30°C	99%	97%	96%	95%	95%	94%	93%	92%	90%
35°C	98%	96%	96%	95%	95%	94%	93%	92%	90%
40°C	98%	96%	95%	94%	94%	93%	92%	91%	89%
45°C	97%	95%	94%	93%	93%	92%	91%	90%	88%
50°C	96%	94%	94%	93%	93%	92%	91%	90%	88%
55°C	96%	94%	93%	92%	91%	90%	90%	89%	87%
60°C	95%	93%	92%	91%	91%	90%	89%	89%	86%
65°C	94%	92%	92%	91%	90%	89%	88%	88%	85%

F1 Floodlight 30k lm (Hours)									
Ambient	0	15000	30000	45000	60000	75000	90000	100000	150000
25°C	100%	98%	95%	93%	91%	89%	87%	85%	79%
30°C	99%	97%	94%	92%	90%	88%	86%	84%	78%
35°C	98%	96%	93%	91%	89%	87%	85%	83%	77%
40°C	97%	94%	92%	90%	88%	85%	83%	82%	76%
45°C	96%	93%	91%	88%	86%	84%	82%	81%	74%
50°C	94%	92%	90%	87%	85%	83%	81%	79%	72%
55°C	93%	91%	88%	86%	84%	81%	79%	78%	71%
60°C	92%	90%	87%	85%	82%	80%	78%	76%	70%
65°C	91%	88%	86%	84%	81%	79%	77%	75%	68%

DISCLAIMER. All product information provided is, to the best of Dialight's knowledge, accurate as of the date of publication. When ordering, refer to www.dialight.com for current versions of: (a) relevant product documentation (including the relevant product data sheets); (b) Dialight terms and conditions of sale; and, (c) the relevant product warranty. To the extent that any contract is deemed formed between Dialight and the purchaser of Dialight products and/or an end-user, versions of documents available at www.dialight.com as at the date of sale shall be the versions incorporated therein. In the event of any discrepancy between this document or information provided at www.dialight.com, the latter shall prevail.

Lumen Maintenance Factor - F2

F2 Floodlight 36k lm (Hours)									
Ambient	0	15000	30000	45000	60000	75000	90000	100000	150000
25°C	100%	98%	97%	96%	96%	95%	94%	93%	91%
30°C	99%	97%	96%	96%	95%	94%	93%	93%	90%
35°C	98%	97%	96%	95%	94%	93%	92%	92%	89%
40°C	98%	96%	95%	94%	93%	93%	92%	91%	89%
45°C	97%	95%	94%	94%	93%	92%	91%	91%	88%
50°C	96%	94%	94%	93%	92%	91%	90%	90%	87%
55°C	96%	94%	93%	92%	91%	90%	90%	89%	87%
60°C	95%	93%	92%	91%	91%	90%	89%	88%	86%
65°C	94%	92%	92%	91%	90%	89%	88%	88%	85%

F2 Floodlight 60k lm (Hours)									
Ambient	0	15000	30000	45000	60000	75000	90000	100000	150000
25°C	100%	98%	95%	93%	91%	89%	87%	85%	79%
30°C	99%	96%	94%	92%	90%	88%	86%	84%	78%
35°C	98%	95%	93%	91%	88%	86%	84%	83%	76%
40°C	96%	94%	92%	89%	87%	85%	83%	81%	75%
45°C	95%	93%	90%	88%	86%	83%	81%	80%	73%
50°C	94%	91%	89%	87%	84%	82%	80%	78%	72%
55°C	93%	90%	88%	85%	83%	80%	78%	77%	70%

DISCLAIMER. All product information provided is, to the best of Dialight's knowledge, accurate as of the date of publication. When ordering, refer to www.dialight.com for current versions of: (a) relevant product documentation (including the relevant product data sheets); (b) Dialight terms and conditions of sale; and, (c) the relevant product warranty. To the extent that any contract is deemed formed between Dialight and the purchaser of Dialight products and/or an end-user, versions of documents available at www.dialight.com as at the date of sale shall be the versions incorporated therein. In the event of any discrepancy between this document or information provided at www.dialight.com, the latter shall prevail.

Dimensional Drawings

F1 Slipfitter Bracket - CE/RCM

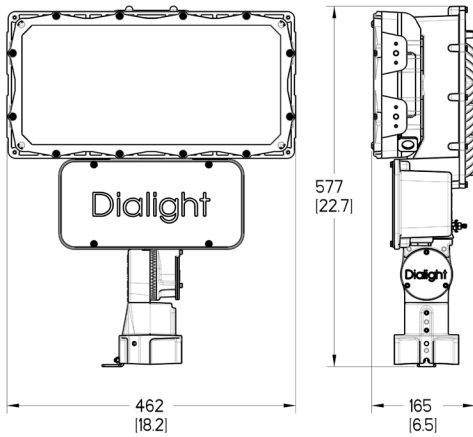

F1 Straight Bracket

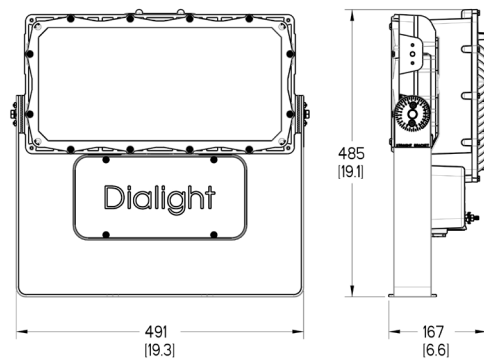

F2 Straight Bracket

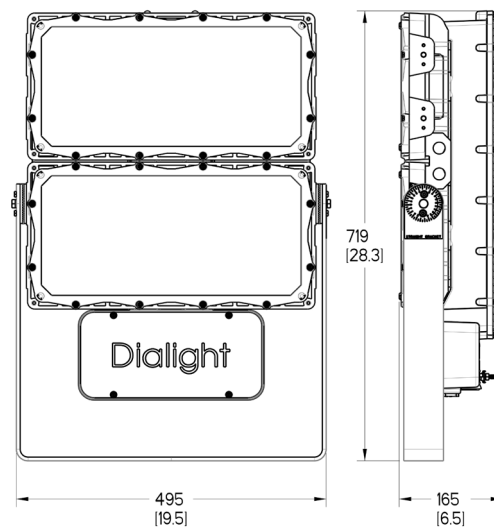

Dimensions in mm [inches]

DISCLAIMER. All product information provided is, to the best of Dialight's knowledge, accurate as of the date of publication. When ordering, refer to www.dialight.com for current versions of: (a) relevant product documentation (including the relevant product data sheets); (b) Dialight terms and conditions of sale; and, (c) the relevant product warranty. To the extent that any contract is deemed formed between Dialight and the purchaser of Dialight products and/or an end-user, versions of documents available at www.dialight.com as at the date of sale shall be the versions incorporated therein. In the event of any discrepancy between this document or information provided at www.dialight.com, the latter shall prevail.

Dimensional Drawings

F1 Mounting Bracket

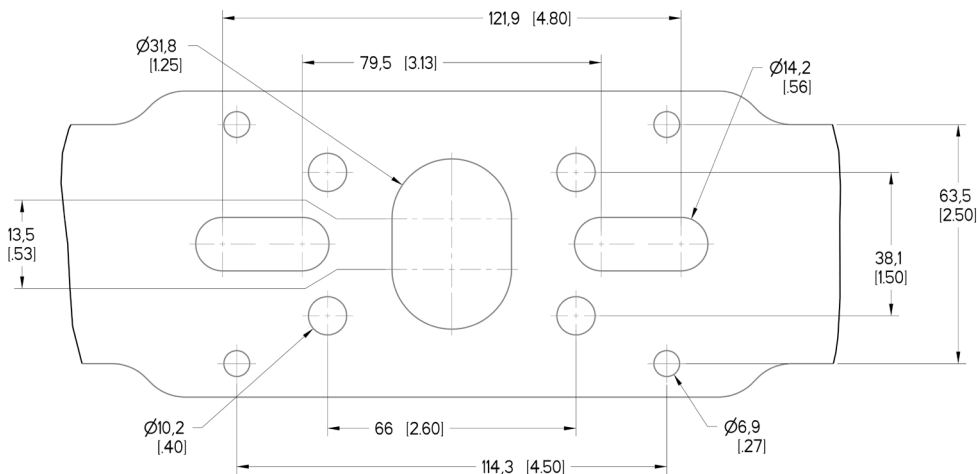

F2 Mounting Bracket

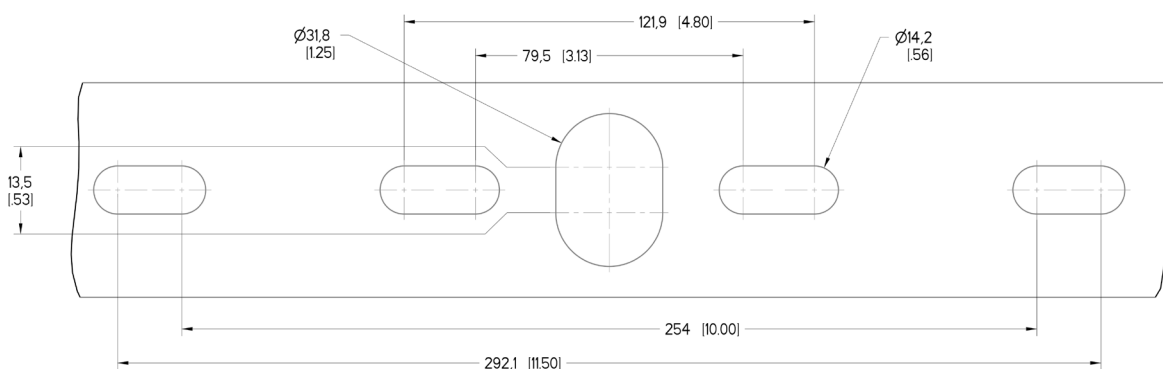

Dimensions in mm [inches]

DISCLAIMER. All product information provided is, to the best of Dialight's knowledge, accurate as of the date of publication. When ordering, refer to www.dialight.com for current versions of: (a) relevant product documentation (including the relevant product data sheets); (b) Dialight terms and conditions of sale; and, (c) the relevant product warranty. To the extent that any contract is deemed formed between Dialight and the purchaser of Dialight products and/or an end-user, versions of documents available at www.dialight.com as at the date of sale shall be the versions incorporated therein. In the event of any discrepancy between this document or information provided at www.dialight.com, the latter shall prevail.

Accessories



F1NVISOR

- F1 visor NEMA optics



F2NVISOR

- F2 visor NEMA optics



F2AVISOR

- F2 visor asymmetric optics
- Not suitable for asymmetric wide optic



H6XCAB72¹

- 72" stainless steel safety rope
- Kit includes: (1) cable

H6XCAB60¹

- 60" stainless steel safety rope
- Kit includes: (1) cable

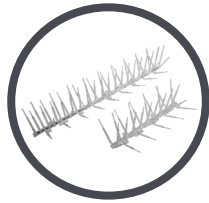

F1SPIKES

F2SPIKES

- Bird spikes

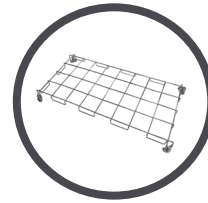

FLWG

- Wire guard
- Kit includes (1) assembly

¹F1 models require 1 cable per unit. F2 models require 2 cables per unit.

Replacements*



SLPC01R

- Photocell, 105-305 VAC

SLPC02R

- Photocell, 312-382 VAC

SLPC03R

- Photocell, 432-528 VAC



FLWIRELESS

- Wireless controls card



FL10KV277

- 10kV surge protection 100-277V

FL10KV480

- 10kV surge protection 347-480V

Replacement Power Supplies	
Part Number	Description
F1PS2B	120-277V Power Supply, 12k lm
F1PS2C	120-277V Power Supply, 18k lm
F1PS2E	120-277V Power Supply, 24k lm
F1PS2F	120-277V Power Supply, 30k lm
F2PS2N	120-277V Power Supply, 60k lm
F1PS5B	347-480V Power Supply, 12k lm
F1PS5C	347-480V Power Supply, 18k lm
F1PS5E	347-480V Power Supply, 24k lm
F1PS5F	347-480V Power Supply, 30k lm
F2PS5N	347-480V Power Supply, 60k lm

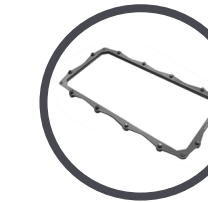

FLGLASSLG

- Glass lens, grey

FLPCLG

- Polycarb lens, grey

- Kit includes (1) assembly

*Replacements parts for CE models only.

DISCLAIMER. All product information provided is, to the best of Dialight's knowledge, accurate as of the date of publication. When ordering, refer to www.dialight.com for current versions of: (a) relevant product documentation (including the relevant product data sheets); (b) Dialight terms and conditions of sale; and, (c) the relevant product warranty. To the extent that any contract is deemed formed between Dialight and the purchaser of Dialight products and/or an end-user, versions of documents available at www.dialight.com as at the date of sale shall be the versions incorporated therein. In the event of any discrepancy between this document or information provided at www.dialight.com, the latter shall prevail.

Australia

108 Howe Street
Osborne Park, WA 6017
Tel: +61 (0) 8 9244 7600
Fax: +61 (0) 8 9244 7601
info@dialight.com.au

Southeast Asia

56 Kallang Pudding Road
#09 – 08 HH@Kallang
Singapore 349328
Tel: +65 6578 7271
Fax: +65 6578 7150
enquiry@dialight.com.sg

WARNING / DISCLAIMERS:

Installation & secondary retention. The use of this product without proper installation (including secondary retention / netting) and periodic inspections, could cause severe injury or death. Dialight recommends that all installations should use secondary retention / netting (appropriate to the installation environment) as applicable. Dialight products are intended for ultimate purchase, installation and operation by knowledgeable persons trained in the functional assessment, installation, use and maintenance of such products and all customers (including but not limited to end customers) are responsible for assessing the suitability of Dialight products for any given installation requirement. It is the exclusive responsibility of the contractor, installer and/or end-user to: (a) determine the suitability of the product for its intended application; and, (b) ensure that the product is safely installed (with secondary retention / netting as appropriate) and in compliance with all applicable laws and regulations.

Product specifications & warranties. All product information provided is, to the best of Dialight's knowledge, accurate as of the date of publication. All values and performance data herein are design or typical values when measured under laboratory conditions. The information herein is subject to change without notice. The products / software detailed herein are subject to applicable warranties and terms and conditions of use/purchase. Unless agreed otherwise in writing by an authorized representative of Dialight, Dialight does not represent that its products are fit for any particular purpose and accepts no liability for the installation and/or unauthorised use of its products. When ordering, refer to www.dialight.com for current versions of: (a) relevant product documentation (including relevant product data sheets); (b) Dialight terms and conditions of sale; and, (c) the relevant product warranties. To the extent that any contract is deemed formed between Dialight and the purchaser of Dialight products and/or an end-user, versions of documents available at www.dialight.com as at the date of sale shall be the versions incorporated therein. In the event of any discrepancy between this document and information provided at www.dialight.com, the latter shall prevail.

Exclusion of liability. To the extent permissible under the relevant law, Dialight disclaims all liability for personal injury and/or other damage resulting from any dislodgment or other dislocation of its products. Whilst Dialight has used its reasonable endeavours to ensure the completeness and accuracy of information herein, Dialight does not assume any liability for damages resulting from use of this information or for any third-party representations made in relation to Dialight products.